

# IBS60M

## KEY FEATURES



years  
**Product  
Warranty**



years  
**Performance  
Warranty**



Cell efficiency  
up to **21.0 %**



Module efficiency  
up to **19.0 %**



Heavy snow load  
up to **5,400 Pa**



Wind load  
up to **2,400 Pa**



**PID Free**



## ELECTRICAL PARAMETERS

| Model                          | IBS60M     |            |            |            |            |            |
|--------------------------------|------------|------------|------------|------------|------------|------------|
| Maximum Power (Pmax/W)         | <b>275</b> | <b>280</b> | <b>285</b> | <b>290</b> | <b>295</b> | <b>300</b> |
| Operating Voltage (Vmpp/V)     | 31.2       | 31.3       | 31.4       | 31.5       | 31.6       | 31.7       |
| Operating Current (Impp/A)     | 8.82       | 8.95       | 9.08       | 9.21       | 9.34       | 9.47       |
| Open-Circuit Voltage (Voc/V)   | 38.2       | 38.4       | 38.5       | 38.6       | 38.7       | 38.8       |
| Short-Circuit Current (Isc/A)  | 9.24       | 9.37       | 9.49       | 9.62       | 9.75       | 9.88       |
| Module Efficiency $\eta_m$ (%) | 16.90      | 17.21      | 17.52      | 17.83      | 18.13      | 18.44      |
| Power Tolerance                | 0+5 Wp     |            |            |            |            |            |
| NOCT                           | 45±2°C     |            |            |            |            |            |

Values at Standard Test Conditions STC (AM 1.5, Irradiance 1000 W/m<sup>2</sup>, Cell Temperature 25°C)

## SPECIFICATIONS

|                          |                                      |
|--------------------------|--------------------------------------|
| Cell Type                | Mono Crystalline                     |
| Cells size               | 156x156 mm                           |
| Number of cells          | 60                                   |
| Weight                   | 18.0 kg                              |
| Front side glass         | 3,2 mm hardened solar tempered glass |
| Dimensions               | 1,640x992x35 mm                      |
| Cable length             | 900 mm                               |
| Cable cross section size | 4 mm <sup>2</sup>                    |
| Number of bypass diodes  | 3                                    |
| Connectors               | MC4 compatible                       |
| Frame                    | Anodized Aluminium Alloy             |
| Junction Box             | IP67                                 |

## ENGINEERING DRAWINGS

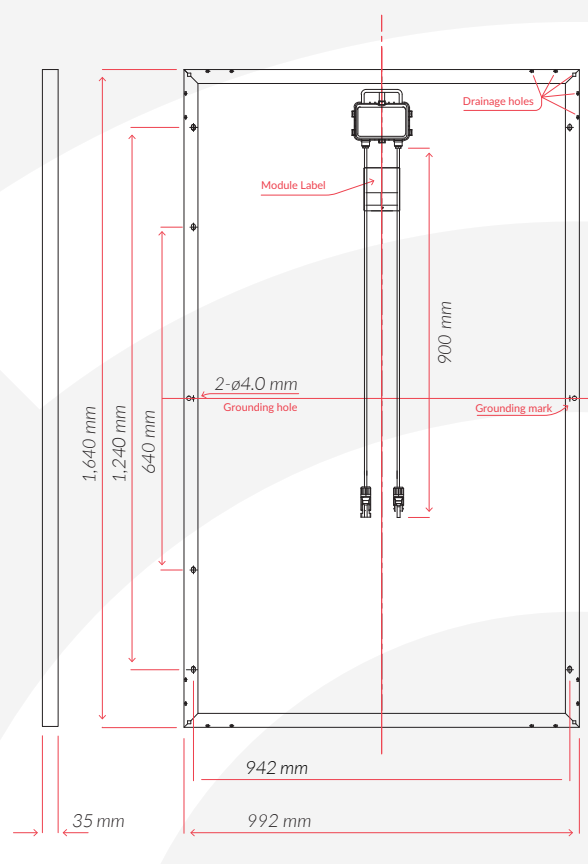

## WORKING CONDITIONS

|                         |                  |
|-------------------------|------------------|
| Maximum System Voltage  | DC 1,000 V (IEC) |
| Operating temperature   | -40°C / +85° C   |
| Maximum reverse current | 15 A             |
| IP protection level     | IP65             |
| Safety class            | II               |

## TEMPERATURE COEFFICIENTS

|                                       |            |
|---------------------------------------|------------|
| Power temperature coefficient (Pmax)  | -0,41 %/°C |
| Voltage temperature coefficient (Voc) | -0,31 %/°C |
| Current temperature coefficient (Isc) | +0,05 %/°C |



## PACKAGING INFORMATION (I)

|                  |                      |
|------------------|----------------------|
| Pallet dimension | 1,700/1,130/1,110 mm |
| Pallet weight    | 590 kg               |
| Modules/pallet   | 30                   |

## PACKAGING INFORMATION (II)

| Container             | 20 GP | 40 GP | 40 HQ |
|-----------------------|-------|-------|-------|
| Pallets per container | 12    | 28    | 28    |
| Pieces per container  | 360   | 840   | 924   |

## PARTNERS